

Sandpit with Facade

MSC541801

KOMPANI
Let's play



This fantastic sandpit will inspire children to play for long periods of time, as they will have many opportunities to manipulate the sand and play side by side or along with others. Sand and water play is serious play for young children, who benefit greatly from opportunities to experiment with the properties of natural materials with their fingers, hands, and arms.

This play gives important input to the senses, and strengthens motor planning as well as fine motor skills. The sandpit has ample room for young children to play. The manipulatable objects and the window space enhance the play experiences. This structure is not only attractive but has many benefits for young children who stay, play, and develop.

Item no. MSC541801-3417P

General Product Information

Dimensions LxWxH	180x139x131 cm
Age group	6m+
Play capacity (users)	10
Color options	

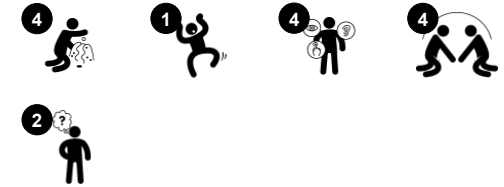

Sandpit with Facade

MSC541801



Panels of 19mm EcoCore™. EcoCore™ is a highly durable, eco friendly material, which is not only recyclable after use, but also consists of a core produced from 100% recycled post consumer material from food packing waste.

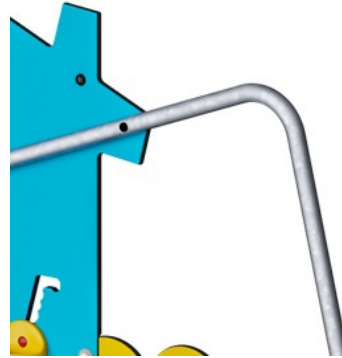

The steel surfaces are hot dip galvanised inside and outside with lead free zinc. The galvanisation has excellent corrosion resistance in outside environments and requires low maintenance.



Play activities like the Funnel are made of injection moulded high quality nylon (PA6). PA6 has good wearing and impact strength and is UV stabilised.

Item no. MSC541801-3417P	
Installation Information	
Max. fall height	0 cm
Safety surfacing area	18.4 m ²
Total installation time	6.9
Excavation volume	0.26 m ³
Concrete volume	0.00 m ³
Footing depth (standard)	60 cm
Shipment weight	155 kg
Anchoring options	In-ground ✓ Surface ✓
Warranty Information	



Sand pipe is made from rotomoulded PE. PE has high impact resistance across a wide temperature span which ensures durability.



Sand strainer is made of high-quality stainless steel to ensure durability of the product.



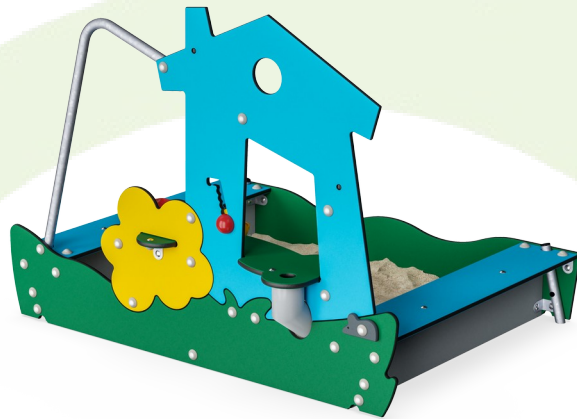

Cradle to Gate A1-A3	Total CO ₂ emission	CO ₂ e/kg	Recycled materials
	kg CO ₂ e	kg CO ₂ e/kg	%
MSC541801-3417P	160.30	1.92	66.90

The overall framework applied for these factors is the Environmental Product Declaration (EPD), which quantifies "environmental information on the life cycle of a product and enable comparisons between products fulfilling the same function" (ISO, 2006). This follows the structure and applies a Life-Cycle Assessment approach to the entire Product stage from raw material through manufacturing (A1-A3))

Kompan A/S
 C.F. Tietgens Boulevard 32C
 DK-5220 Odense SØ
 Denmark



Validation of CO₂ calculation of: Themed play systems

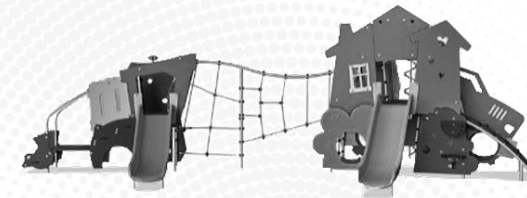

Data version no. 2021-09-27

The CO₂ calculation and data are in compliance with the principles of a carbon footprint impact according to the GHG protocol (Greenhouse Gas Protocol), Scope 3, cradle to gate related to all individual components in the product category: "Themed play systems" represented by item no.: MSC641100-3717P.

(Scope 3 emissions include emission sources in the upstream and downstream value chain).

Date: 15. October 2021 | Valid until: 15. October 2023

Validated by:

Bente Hviid, Senior Consultant

Peter Bendtsen, Senior Consultant

Validation based on report: Validation of CO₂ calculation of 8 categories of Kompan product line, version 1.0, prepared by: Bureau Veritas HSE, Denmark: Bente Hviid and Peter Bendtsen.

Publication date: 15. October 2021

By Bureau Veritas HSE
 www.bureauveritas.dk
 +45 7731 1000



Sandpit with Facade

MSC541801

* Max fall height | ** Total height | *** Safety surfacing area

* Max fall height | ** Total height

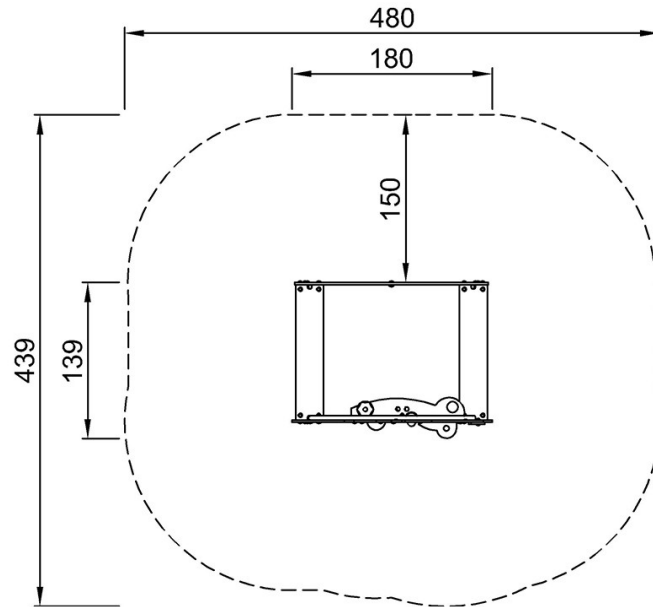

MSC541801P
**131cm
***18.4m²

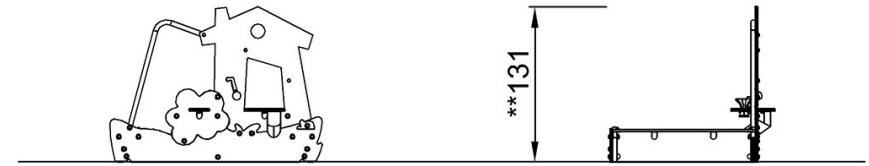

MSC541801P

[Click to see TOP VIEW](#)

[Click to see SIDE VIEW](#)